

Instruction Booklet

RX-108

Please read all instructions
carefully before opening box



1

PULL YOUR REXframe®
FABRIC OUT OF THE BOX
& UNWRAP YOUR
EXTRUSION

CAREFUL NOT TO CUT
INTO THE BAGS OR THE BOX
AS YOU COULD DAMAGE
THE FABRIC



2

INSERT ELBOW JOINERS INTO THE CHANNELS
AS SHOWN BELOW, REPEAT FOR ALL
HORIZONTAL LENGTHS

***NOTE**
IF YOU ARE USING
RX-204 HD ELBOW
INSERT INTO THIS
CHANNEL

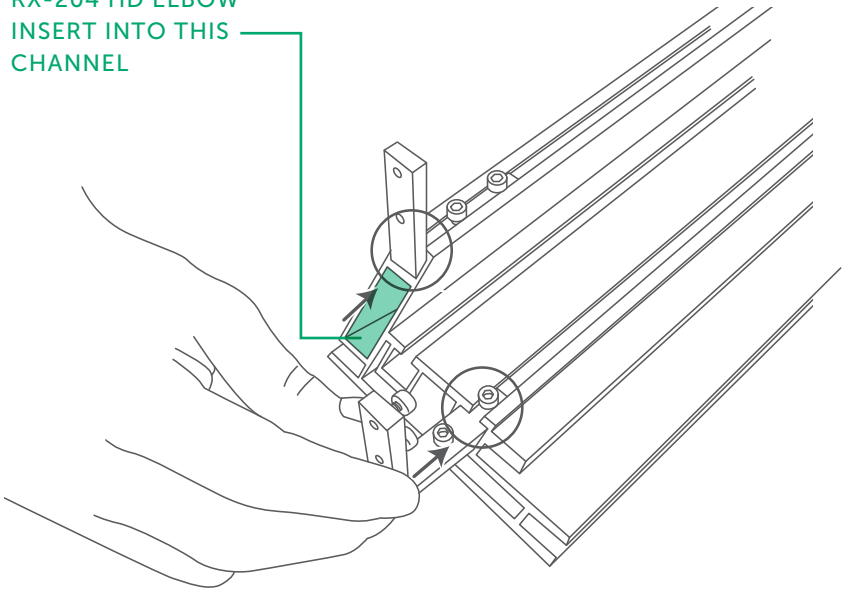

3

ONCE THE LENGTHS ARE FULLY
INSERTED, TIGHTEN SCREWS
WITH SUPPLIED ALLEN KEY
TO LOCK INTO PLACE

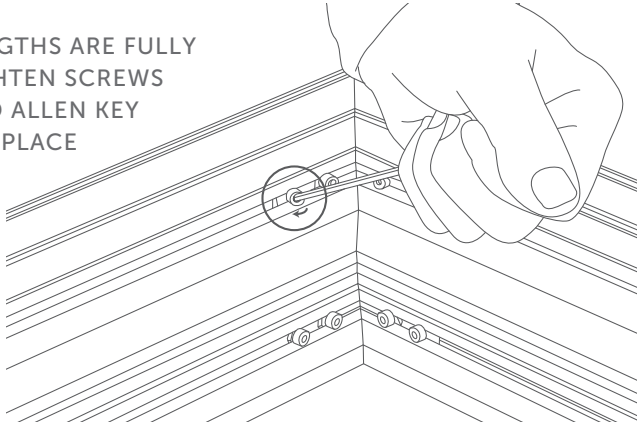

4

INSERT CORNER
BRACKET INTO THE REAR
CHANNEL CORRESPONDING
WITH THE ELBOW JOINER

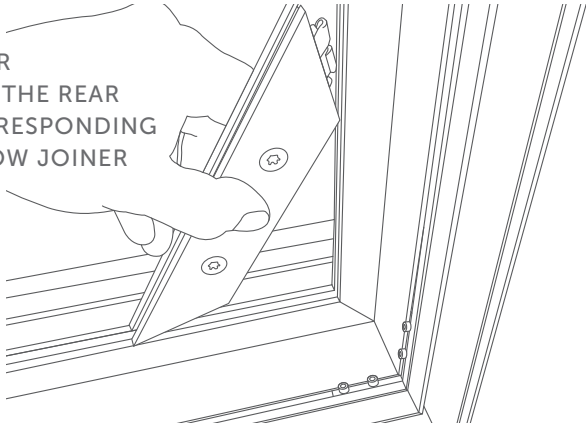

5

TIGHTEN LOCKING SCREWS
USING SUPPLIED LOCK KEY

REPEAT FOR REMAINING
CORNERS

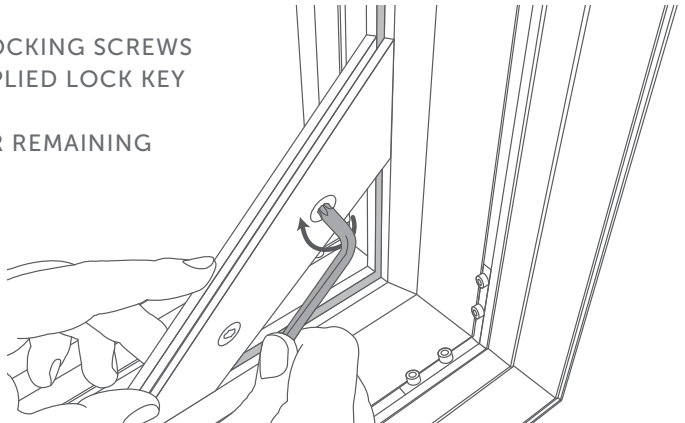

6

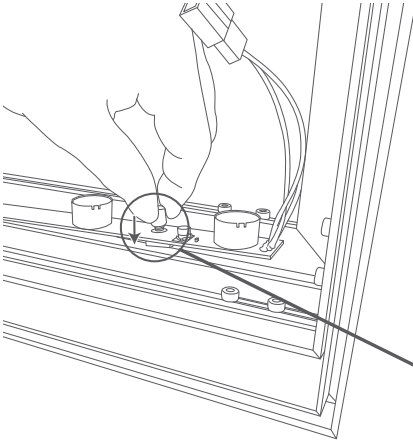

ENSURE TO INSTALL LIGHTS IN THE CHANNEL THAT DOES NOT HAVE A CORNER BRACKET - USE THE MIDDLE CHANNEL.

TIGHTEN LIGHTS IN POSITION USING YOUR HANDS BY TWISTING THE T-NUT IN A CLOCKWISE DIRECTION

***Important Note*:** if the t-nut falls out from the LED Module, but sure to put the rubber washer back on the top side of the LED Light.

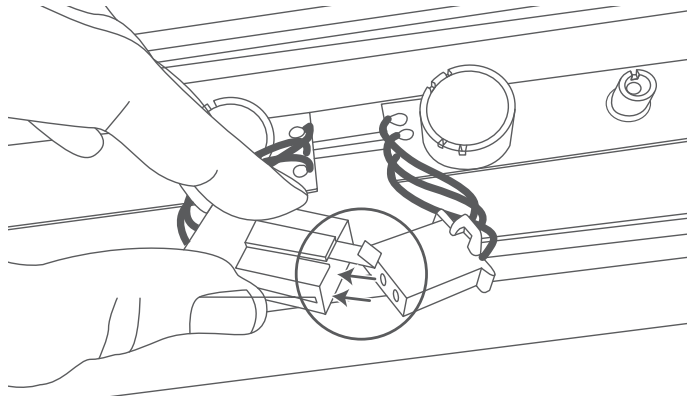
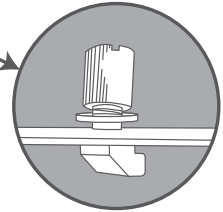

7

CONNECT THE LED MODULES TOGETHER

***NOTE IF YOU ARE USING A HARNESS - FOLLOW YOUR SUPPLIED LIGHTING DIAGRAM**

8

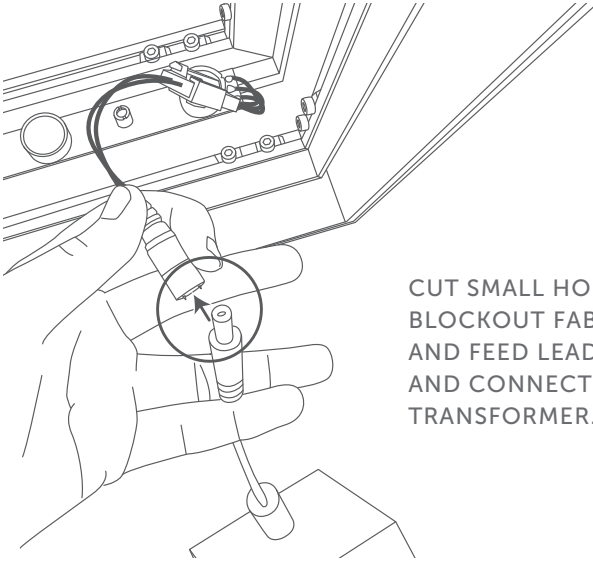

CUT SMALL HOLE IN
BLOCKOUT FABRIC ON REAR
AND FEED LEAD THROUGH
AND CONNECT TO
TRANSFORMER.

9

INSERT THE FABRIC INTO THE EXTRUSION STARTING WITH THE CORNERS ENSURE THE SILICON GASKET IS CONCEALED

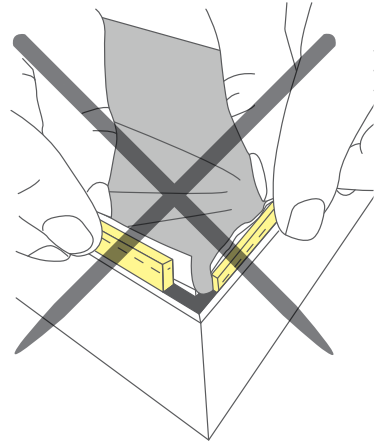
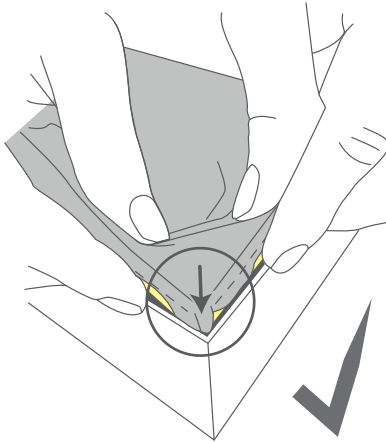

10

FOLLOW THE DIAGRAM BELOW FOR THE REMAINING SILICON GASKET EDGE.

STARTING WITH ALL CORNERS

ENSURE SILICON GASKET EDGE ON FABRIC IS PUSHED AS FAR INTO THE CHANNEL AS POSSIBLE, THIS SHOULD SUBSIDE ANY WRINKLES THAT MAY HAVE APPEARED.



Inserting Fabric

11

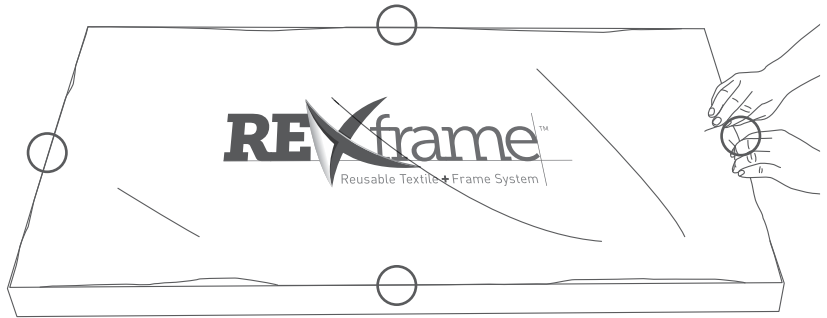

CONTINUE WITH THE MIDDLE OF EACH LENGTH,
AND THEN THE REMAINDER OF THE FABRIC

12

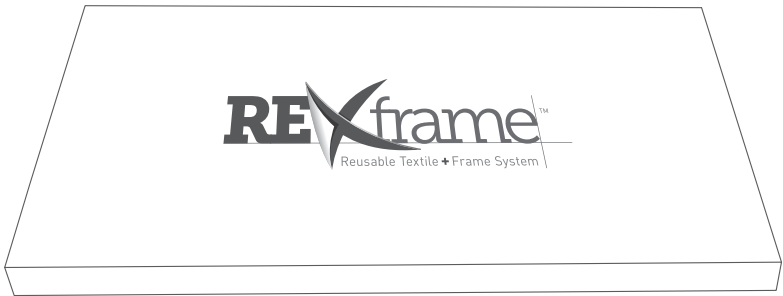

CONTINUE UNTIL ALL THE FABRIC HAS BEEN FULLY INSERTED